

# LEARN MORE ABOUT YOUR WB-1750

Visit the WB-1750, Wireless Gaming Bridge Product Page online to find:

- Instructions for Different Set Up Scenarios
- Frequently Asked Questions
- Product User Manual
  - How to Access the Web User Interface
  - How to change your SSID & Password
  - And More!

To visit the WB-1750 Product Page  
scan the QR Code or visit:

[www.nexuslinkusa.com/product/wb-1750](http://www.nexuslinkusa.com/product/wb-1750)



## HAVE QUESTIONS?

We're Here to Help!



<http://nexuslinkusa.com/support>



Support: (855) 313-4433

Remember to connect with us on social media for  
product updates, giveaways, and new releases!



[twitter.com/nexuslinkusa](https://twitter.com/nexuslinkusa)



[facebook.com/nexuslinkusa](https://facebook.com/nexuslinkusa)



[instagram.com/nexuslink\\_us](https://instagram.com/nexuslink_us)



[youtube.com/nexuslinkusa](https://youtube.com/nexuslinkusa)



## QUICK INSTALL GUIDE

AC1750 Wireless Gaming Bridge  
WB-1750

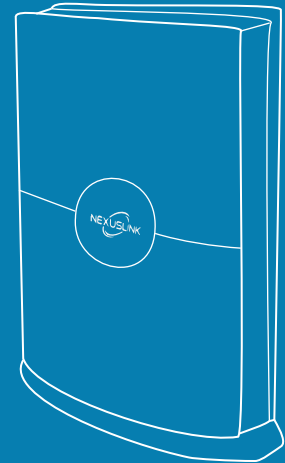

START HERE →

# PACKAGE CONTENTS



1 AC1750 Wireless Gaming Bridge

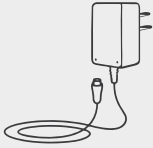

1 AC Power Adapter



1 RJ-45 Ethernet Cable



1 WB-1750 Quick Install Guide

## ⚠ Before you start:

This is the correct Quick Install Guide for you if you are connecting a WiFi device, like a VR Headset!

Visit [nexuslinkusa.com/product/wb-1750](https://nexuslinkusa.com/product/wb-1750) to find out what more you can do with NexusLink's Wireless Bridge!

## A Initial Wireless Bridge Set Up

*Note: The Wireless Bridge should already be set to AP mode. If it is not, please slide the AP/Station Switch to the AP upward position.*

- 1 Plug the Power Adapter into the Wireless Bridge and press the Power Button to the ON position (IN).

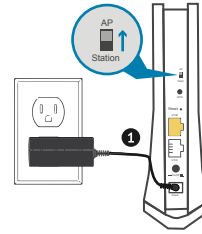

- 2 Connect the Wireless Bridge to your Network via a Router, etc. with an Ethernet (RJ-45) cable. You can use either Ethernet port on the Wireless Bridge to make this connection.

*Note: Is your Wireless Device setup in a remote location away from the router? You can use an additional WB-1750 to connect from remote locations. Visit [nexuslinkusa.com/product/wb-1750](https://nexuslinkusa.com/product/wb-1750) to learn more!*

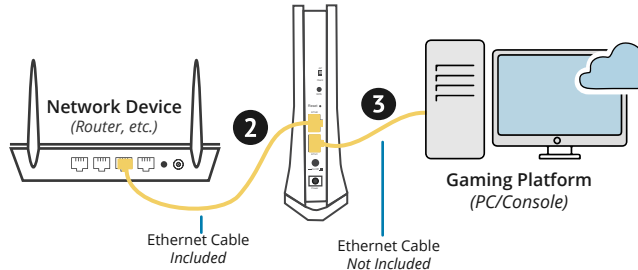

- 3 Connect your wireless bridge to your Gaming Platform (PC/Console) via Ethernet (RJ-45) cable.

## B Connecting Your Wireless Device to the Wireless Bridge

- 4 Find the network name (SSID) and Password (WiFi Key) at the bottom of the WB-1750.

Example:

**SSID :** NexusLinkE221

**WiFi Key :** 265940E221

- 5 On your wireless device (VR Headset, etc.), select the WB-1750's network name from your wireless device's standard list and enter the WiFi Key.
- 6 You're all done! You have successfully connected your Wireless Device to the WB-1750 Wireless Bridge.

